

# IGREJAS COM COBERTURA DE MADEIRA

HISTÓRIA  
DA  
ARQUITECTURA  
PORTUGUESA II



RUI MACHADO  
JOSÉ MURTA  
BRUNA FERREIRA  
ANA SANTOS  
FREDERICO MARTINHO  
JOÃO ARCHER PRATAS

IGREJA DE SANTA MARIA DA ALCÁÇOVA  
MONTE-MOR-O-VELHO  
1090

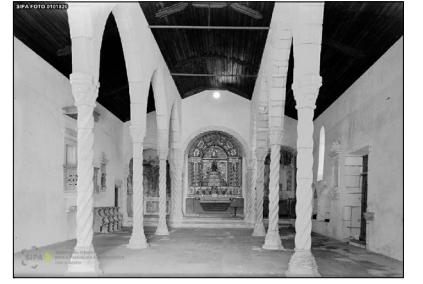
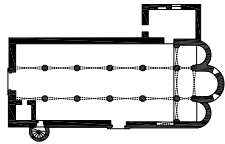

IGREJA DE SANTA MARIA  
SINTRA  
1147

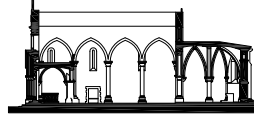
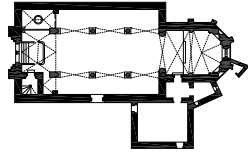

IGREJA DE SANTA MARIA DO OLIVAL  
TOMAR  
1160

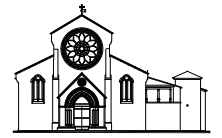
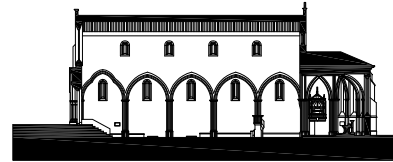
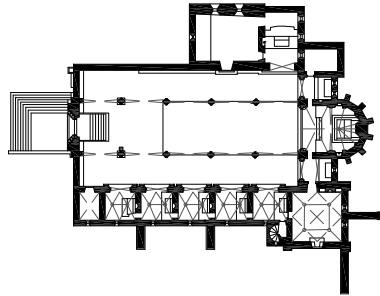

IGREJA DE SANTA CLARA  
SANTARÉM  
1264

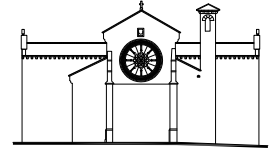
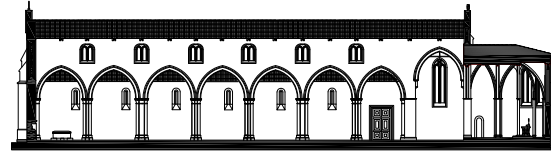
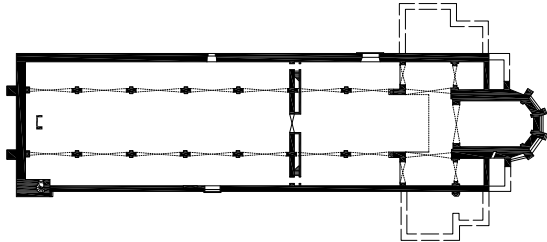

SÉ CATEDRAL  
SILVES  
1279

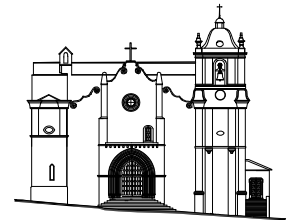
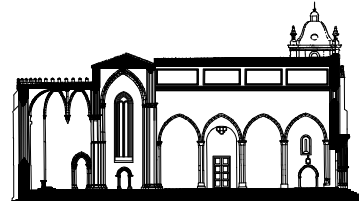
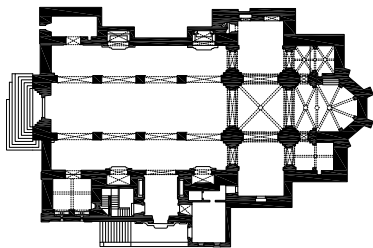

IGREJA DO MOSTEIRO  
LEÇA DO BALIO  
1330

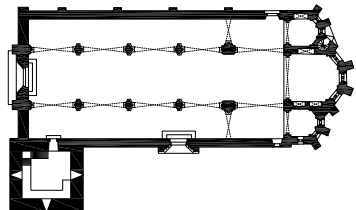

IGREJA DE SANTA MARIA DA GRAÇA  
SANTARÉM  
1380

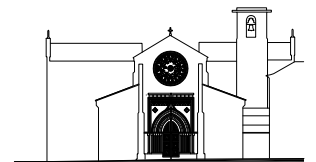
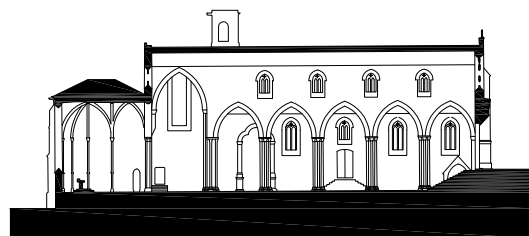
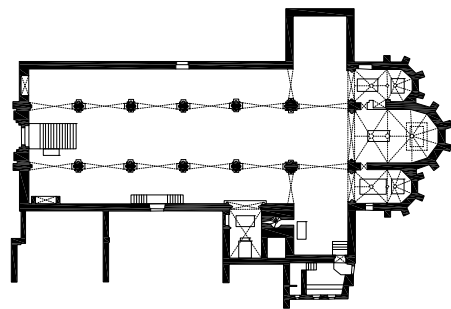

IGREJA MATRIZ  
LOURINHÃ  
1384

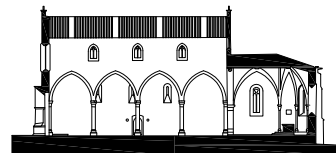
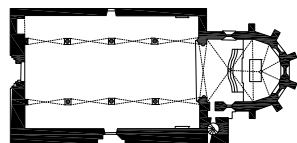

IGREJA DE SANTIAGO  
PALMELA  
1443

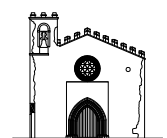
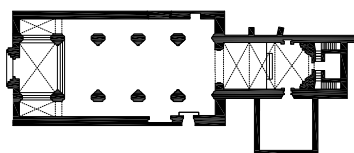

SÉ FUNCHAL  
1488

